

ARC

2026 Gas Class B Motorhome

18C

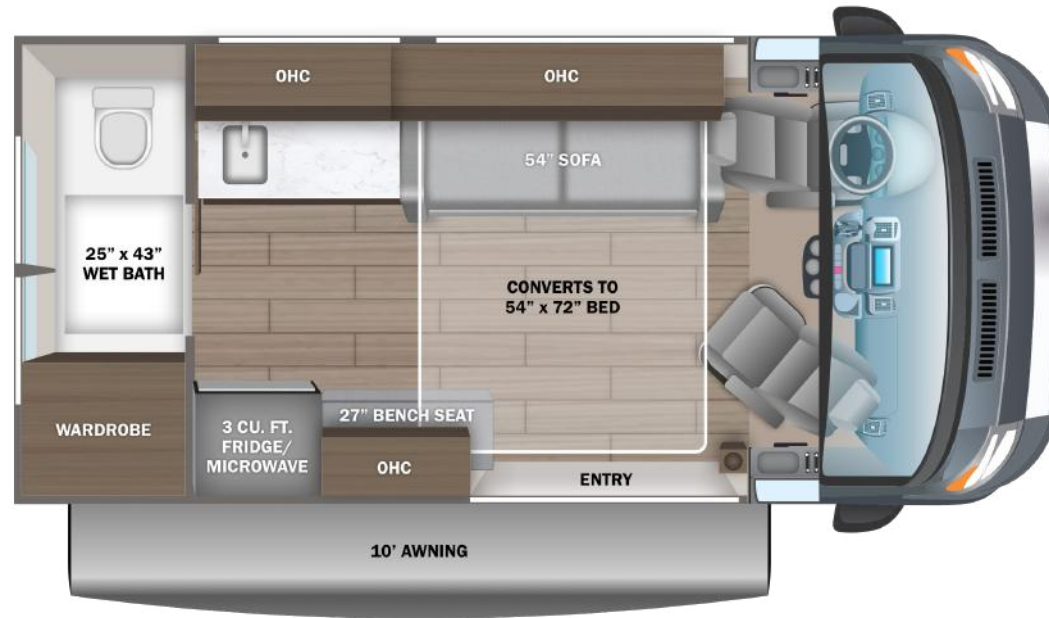

EXTERIOR



CUSTOMER VALUE PACKAGE

Thule® patio awning with LED light strip
 Aqua-Hot® GEN-1 hydronic water and heating system
 Swivel passenger seat with 6-way adjustment
 13,500 BTU Coleman®-Mach® 10 air conditioner
 Hellwig helper spring

STANDARD CHASSIS EQUIPMENT

RAM® ProMaster 1500 cargo van with 136 in. wheelbase
 (2500 cargo van for CSA chassis)
 GVWR - 8,550 lb. (8,900 lb. for CSA chassis)
 GCWR - 12,000 lb.
 3.6L V6 24V VVT 276HP engine with 250 ft.-lb. torque
 9-speed automatic 948TE transmission
 180-amp alternator
 LT225/75R 16E tires
 Aluminum wheels
 3,500 lb. rear hitch receiver with dual 4/7 pin connector
 12V chassis battery
 24 gal. fuel tank (gas)
 10.1 in. Uconnect® 5 NAV infotainment center with
 Apple CarPlay® and Android Auto™
 Power folding/heated side-view mirrors
 Push-button start
 ParkView® rear backup camera with dynamic gridlines
 Blind spot monitoring with rear cross path detection
 LaneSense® lane departure warning with lane keep assist
 Forward collision warning with active braking
 Crosswind assist
 Electronic stability control
 Pedestrian/cyclist emergency braking
 Traffic sign information
 Drowsy driver detection
 Rain-sensitive windshield wipers
 Automatic high-beam headlights
 Cruise control
 Driver and passenger airbags
 Wireless charging pad

Power windows and door locks
 Privacy shades for cab windows
 Remote keyless entry

STANDARD EXTERIOR EQUIPMENT

LED-lit running boards for cab and entry doors
 Chrome grille package
 Onan® 2,800W generator
 1,000W inverter
 (2) 12V AGM house batteries
 House battery disconnect switch
 30-amp electrical service with detachable power cord
 (2) 120V exterior outlets
 Side port solar prep
 Heated holding tanks (12V pads)
 LED-lit holding tank valves
 Gravity water fill
 Winterization drain system
 12V demand water pump
 Water filtration system
 Outside shower

STANDARD INTERIOR EQUIPMENT

Custom-molded ABS interior wall panels
 Soft-touch vinyl ceiling
 High-intensity LED ceiling lights
 Residential vinyl flooring
 Interior command center
 Side screen door with magnetic and zipper close offs
 Sliding vented windows
 Decorative window valances with day/night roller shades
 Rear magnetic privacy shades
 Removable privacy shade for sliding door window
 Adjustable table with multiple mounts
 Seatbelts for driver/passenger seats and select
 cab locations
 Smoke alarm
 Carbon monoxide detector

Fire extinguisher
 3 cu. ft. refrigerator/freezer
 Microwave
 Portable induction cooktop
 Stainless-steel sink
 Pressed countertops
 54 in. sofa converts to 54 in. x 72 in. bed
 Bathroom wardrobe
 Shower with magnetic curtain surround
 Aqua View® SHOWERMISER™ water
 management system
 Cassette toilet
 Medicine cabinet with mirror
 Powered roof vent in bathroom

OPTION

200W roof-mounted solar panel with dual controller



At Entegra Coach, we build our RVs to handle every adventure, then back them with an outstanding warranty. Our 2-year limited warranty has you covered for 2 camping seasons. That's 730 days. For a copy of our 2-year limited warranty with complete terms and conditions, please contact your local Entegra Coach dealer.

Floorplan	GVWR (lbs.)	GCWR (lbs.)	Wheel Base	Overall Length	Exterior Height w/ A/C & Satellite	Exterior Width	Interior Height	Fresh Water Capacity (gal.)	Grey Waste Water Capacity (gal.)	Black Waste Water Capacity (gal.)
18C (US)	8,550	12,000	136"	17' 10"	9' 3"	83"	74"	21	24	4.75
18C (CSA)	8,900	12,000	136"	17' 10"	9' 3"	83"	74"	21	24	4.75

It is important for your safety and enjoyment that you are aware of the weights and tow ratings of the RV you select. Consult a competent advisor for questions or advice. Whether you are new to RVing or a veteran, get a feel for the performance of your RV before heading out on the roadways. When you tow a vehicle with your RV, you must drive differently than when you drive a single vehicle. Practice hooking up, driving, backing up and braking in a safe environment or seek out professional instruction. Jayco affixes a weight label to each RV which lists weight information for that vehicle. Refer to that label to verify the vehicle will meet your requirements. Gross Vehicle Weight Rating (GVWR): The maximum permissible weight of the motorhome, including the Unloaded Vehicle Weight (UVW) plus passengers, personal items, all cargo, fluids, options and dealer-installed accessories. The GVWR is equal to or greater than the sum of the UVW and the Cargo Carrying Capacity. Gross Combined Weight Rating (GCWR): The maximum allowable combined weight of the motorhome used as a tow vehicle and the attached towed vehicle.



Entegra Coach, Inc., P.O. Box 460, Middlebury, IN 46540, www.entegracoach.com. See dealer for further information and prices. All information in this brochure is the latest available at the time of publication approval. Entegra Coach reserves the right to make changes and to discontinue models without notice or obligation. Photos in this brochure may show optional equipment and props for photography purposes. RVs built for sale in Canada may differ to conform to Canadian codes. ©2025 Entegra Coach, Inc. Printed in U.S.A. 2033063



LEGACY ISN'T LEFT,
IT'S LIVED.